

Ph: (269)435-4Art
(4278)
Fax (269)435-4507

www.arestroomtrailer.com



P.O. Box 97
67351 US 131
Constantine, MI 49042

Cellar 112-W Restroom Trailer # 1473

Standard Equipment / Specifications

Trailer Specifications

132"x72"H/D Undercoated Steel Frame
2 5/16 Hitch
5,000lb Torsion Axle W/Brakes
15" Radial Tires W/ 6 Hole Aluminum Wheels
(4) 5000# Pipe Mount Leveling Jacks
Approx. 370 Gallon Waste Tank
7 Way Plug and Break Away Cable
DOT Safety and LED Exterior Lights
Switched Porch Light @ Each Entry Door
Rain Gutter Over Each Entry Door
Seamless Aluminum Roof

Fastenerless Exterior - **Light Pewter**
Solid Flip Up Steps
Waste Tank Sight Gauge & 3" Banjo Valve
Walls-Ceiling-Floor 16" O/C
Walls & Ceiling Insulated
20 AMP Electrical Circuit(s)
Deep Cell Battery W/Disconnect
A/C D/C Converter/Charger
Twist Lock Cord(s)W/ 15AMP Adapter(s)
City Water Hook Up
13,500 BTU Ducted A/C
HVAC Remote Sensor & Drain Kits

Interior Specifications

Custom Cabinetry & Trim-**Barn Wood Style**
Smooth Wall -- **Carmel**
Smooth Fiberglass Ceiling Surface --**White**
H/D Linoleum-**Flatirons**
Corian Solid Surface Counter Tops --**Silt**
Stainless Steel Sinks -**Undermounted**
Metered Faucets/Chrome
Soap Dispensers (mounted in counter top)
Galvanized Accent Wall
China Foot Flush Stools / Waterless Urinal -- White
LED Recessed Ceiling Lights
Safety Backed Glass Mirror (1 per side)
Fresh Water System (Tank Size is 74 Gallons)
On Demand Water Pump

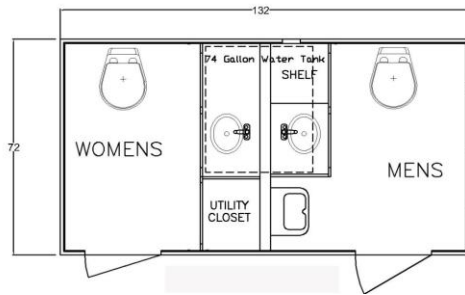

OPTIONS IN RED HAVE BEEN INSTALLED ON UNIT

FRP Laminated Exterior Walls (**White In Color**)- Increases Overall Frame Length and Width by 1"

1 Stone Guard

Extra / RV Style Dump Valve (Location Customers Choice)
Interchangeable Gender Indicators

1 Baseboard Heat Package (1 Heater per Side)

Winter Package (Dump Valve & Waste Tank Heaters, and Insulated Tank)
Extreme Package (Includes Winter Package, Heat in Utility Room, Heated and Insulated Water Lines Running on Exterior Walls in Chase)
Spare Tire (Aluminum Wheel shipped loose --Front Mount Additional)
Front Mount Spare Tire

1 Occupancy Sensors (1 per Side)

1 Stereo System FM/BT/USB/CD (1 Speaker Per Side)

1 Toilet Paper Holders (812 Chrome Surface Mount) 1 per Toilet

1 Paper Towel Dispensers (262 Surface Mount Stainless Steel C-Fold) 1 per Sink

Flush Urinal

1 Hot Water Heater (on separate circuit)

Solar Package W/Two Batteries