



## RESTROOM & SHOWER TRAILERS

All units now available with  
Fiberglass Gelcoat Exterior



*Art is in more  
than our name.*

See our many floor plans or let us customize one to fit your needs. All units are custom built in-house. Starting with steel directly from the mill, we construct a heavy duty built frame and tank designed from the ground up to be a Restroom Trailer not a RV or cargo trailer retrofit. By being builders, and just not assemblers, we are able to customize any unit to the customer's exact specifications or wants. Our standard features and options work well with any event or work site. Both our Restroom and Shower Trailers are designed with a sleek appearance and easy set-up features.

*We build with quality, safety, privacy and ease of set-up in mind.*

## EMBASSY

*(Most popular floor plans available in Embassy)*

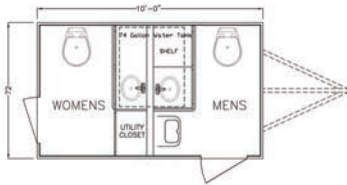

102-W



1203-W

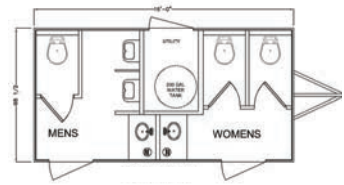

1805-W

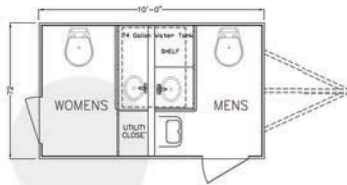

112-W

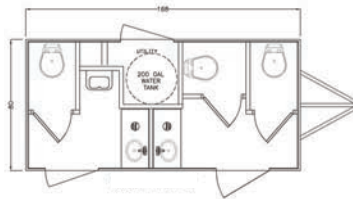

1404-W

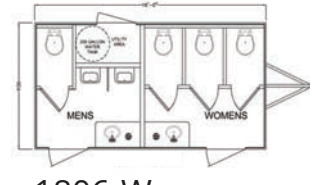

1806-W

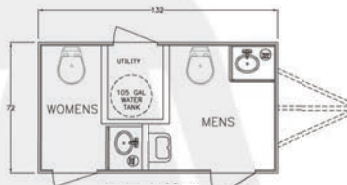

1102-W

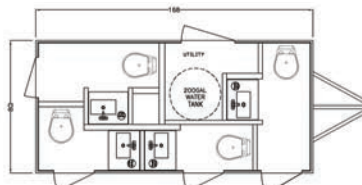

1404-W 4-D

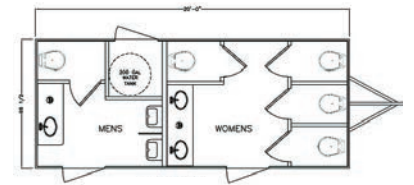

207-W

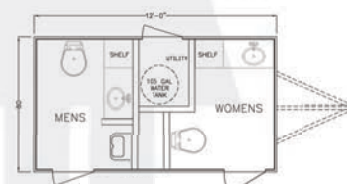

1202-W

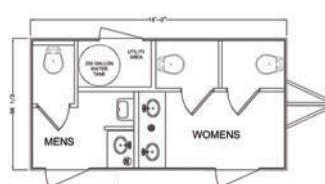

1804-W

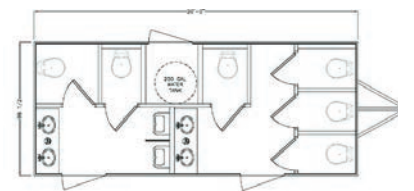

208-W

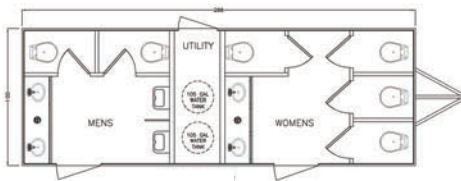
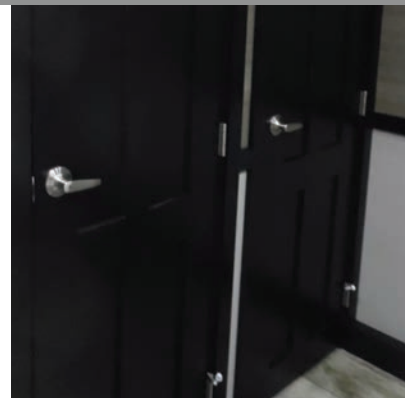
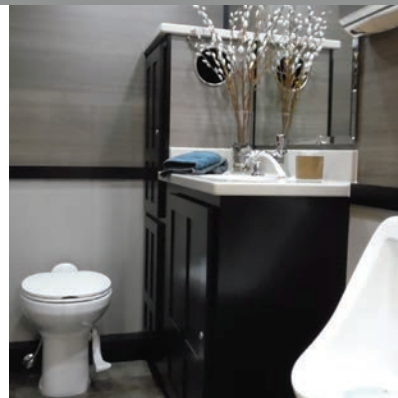
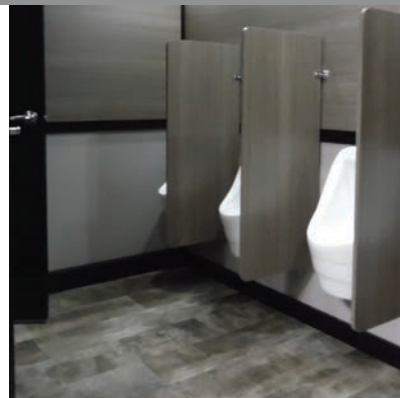

2408-W

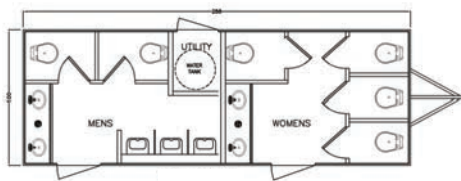

2409-W

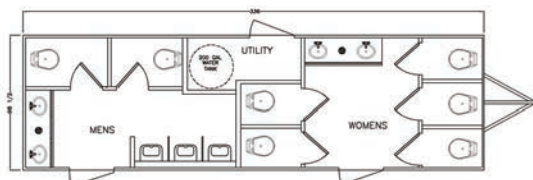

2810-W

Floor plans not printed to scale. See website for additional floor plans.

### Standard Interior Features

- Custom Cabinetry & Trim
- Smooth Fiberglass Ceiling Surface - White
- Heavy Duty Linoleum
- Solid Surface Counter Tops
- Integrated Sink with Chrome Fixtures
- Soap Dispensers (mounted in Counter Tops)
- China Foot Flush Toilets/Waterless Urinals - White
- Recessed LED Ceiling Lighting
- Safety Backed Glass Mirror

Art is in more than our name.



# CELLAR

(Most popular floor plans available in Cellar)

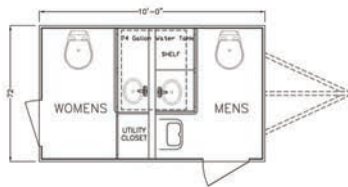

102-W

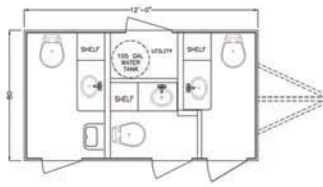

1203-W

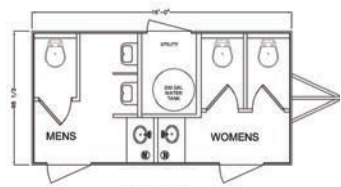

1805-W

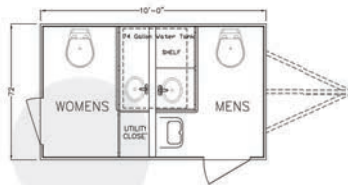

112-W

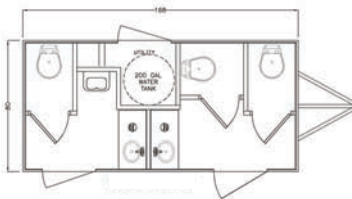

1404-W

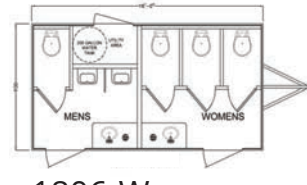

1806-W

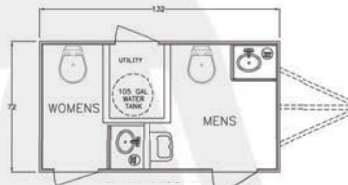

1102-W

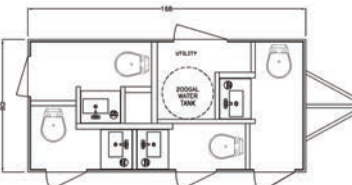

1404-W 4-D

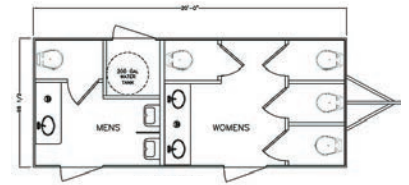

207-W

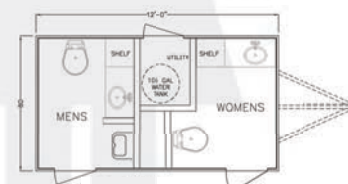

1202-W

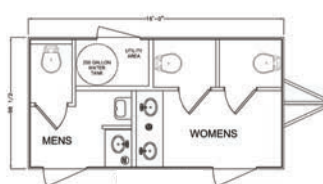

1804-W

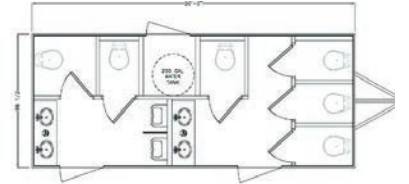

208-W

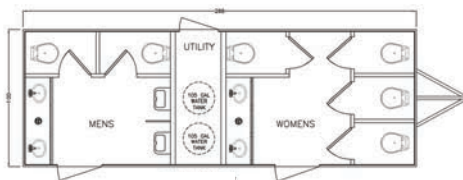
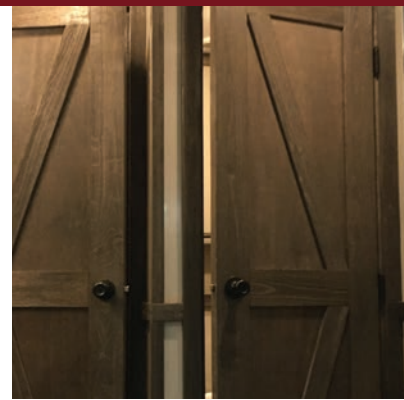

2408-W

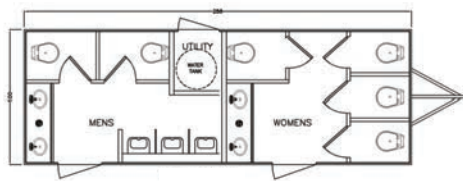

2409-W

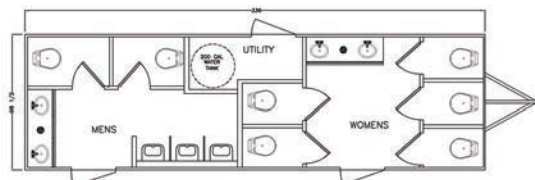

2810-W

## Standard Interior Features

- Custom Cabinetry & Trim - Barn Wood Style
- Smooth Fiberglass Ceiling Surface - White
- Smooth Wall - Tan
- Galvanized Steel Accent Wall
- Shelves (above toilets/urinals)
- Heavy Duty Linoleum
- Solid Surface Counter Tops
- Under Mount Stainless Steel Sinks with Chrome Fixtures
- Soap Dispensers (mounted in Counter Top)
- China Foot Flush Toilets / Waterless Urinals-White
- Recessed LED Ceiling Lighting
- Safety Backed Glass Mirror

\* Standard interior features may vary by floor plan.



# FARMHOUSE

(Most popular floor plans available in Farmhouse)

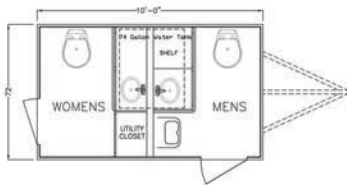

102-W

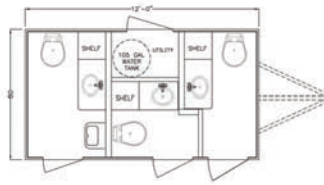

1203-W

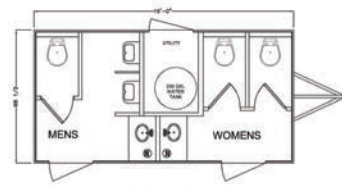

1805-W

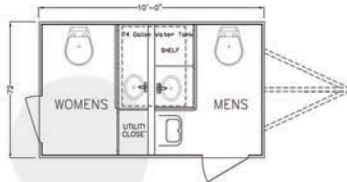

112-W

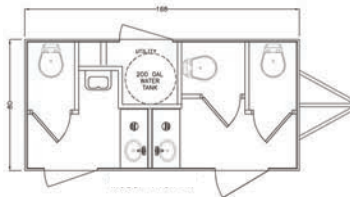

1404-W

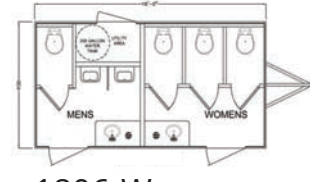

1806-W

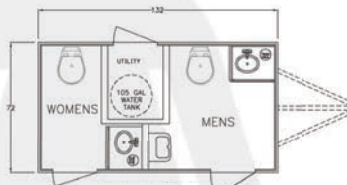

1102-W

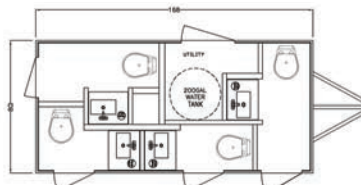

1404-W 4-D

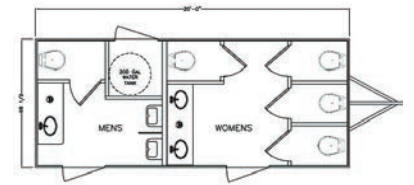

207-W

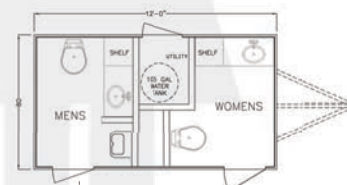

1202-W

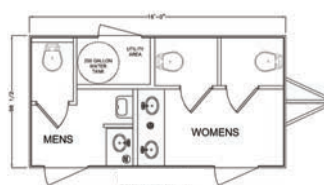

1804-W

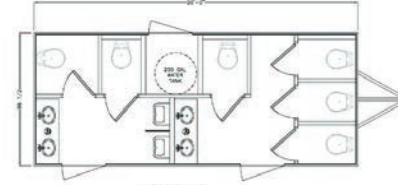

208-W

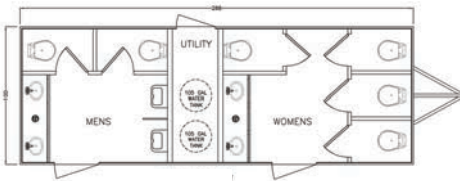

2408-W

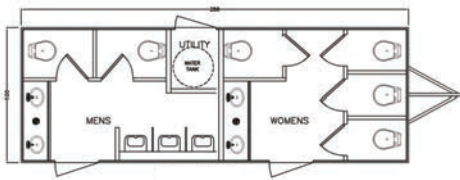

2409-W

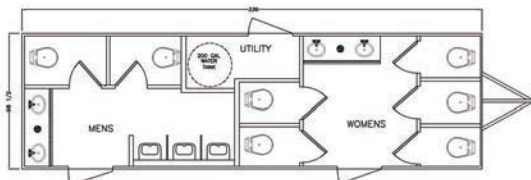

2810-W

### Standard Interior Features

- Composite Cabinetry-White W/Black Hardware
- Composite Trim-White
- Smooth Wall-Tan
- Smooth Fiberglass Ceiling Surface-White
- Shiplap Accent Wall-White
- Heavy Duty Linoleum
- Solid Surface Counter Tops
- Integrated Undermount Square Sink
- Touchless Faucets-Black
- China Foot Flush Stools-White
- Waterless Urinals-White
- LED Recessed Ceiling Lights
- Framed Safety Backed Glass Mirror-Black

**All Plastic Composite Trim**



## LUXURY ESTATE

(Most popular floor plans available in Luxury Estate)

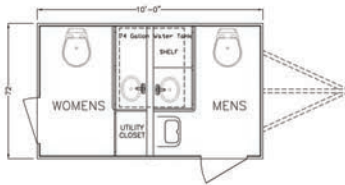

102-W



1203-W

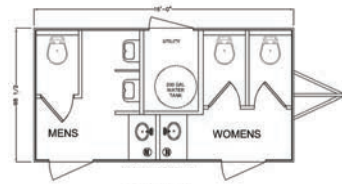

1805-W

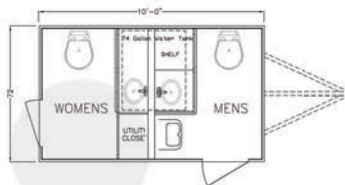

112-W

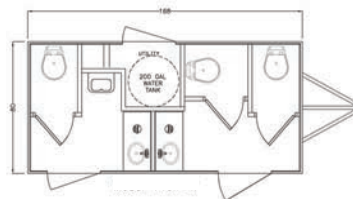

1404-W

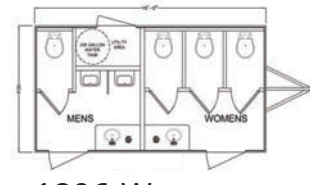

1806-W

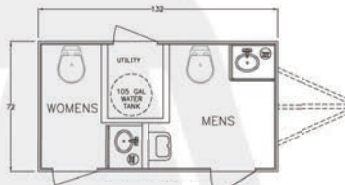

1102-W

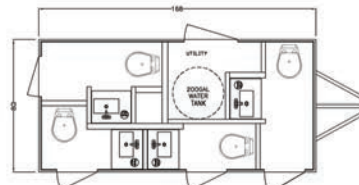

1404-W 4-D

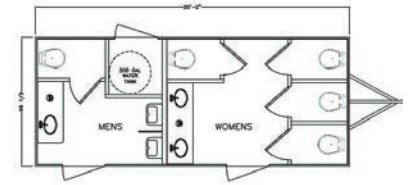

207-W

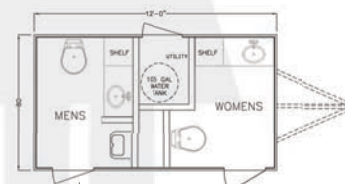

1202-W

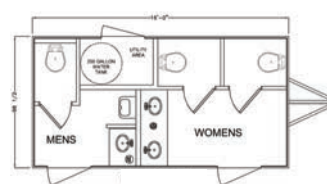

1804-W

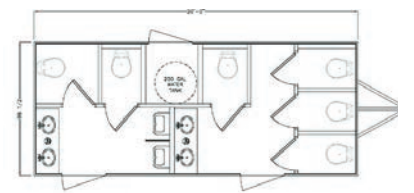

208-W



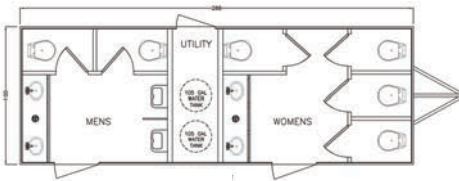

2408-W

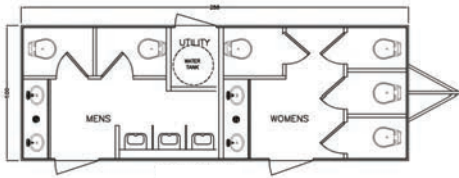

2409-W

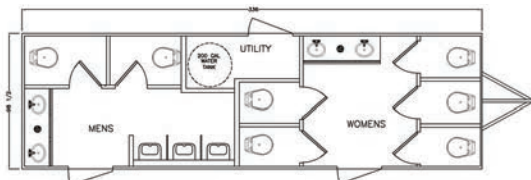

2810-W

## Standard Interior Features

- Custom Cabinetry & Trim - White
- Smooth Wall - Gray
- Top 4' of Wall Smooth Finish - Light Gray
- Bottom Wall Smooth Finish - Dark Gray
- Smooth Fiberglass Ceiling Surface - White
- Shiplap Accent Wall
- Heavy Duty Linoleum
- Solid Surface Counter Tops
- Integrated Undermount Square Sink
- Chrome Fixtures
- Soap Dispensers (mounted in counter top)
- China Foot Flush Toilets/ Waterless Urinals - White
- LED Recessed Ceiling Lights
- Framed Safety Backed Glass Mirror



# ESTATE

(Most popular floor plans available in Estate)

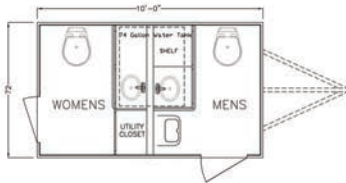

102-W

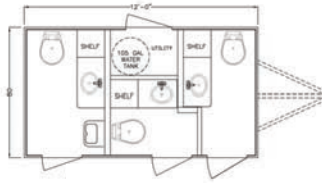

1203-W

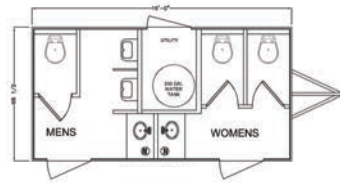

1805-W

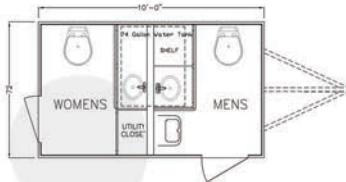

112-W

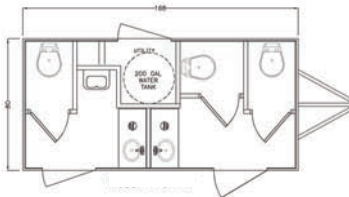

1404-W

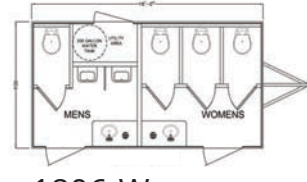

1806-W

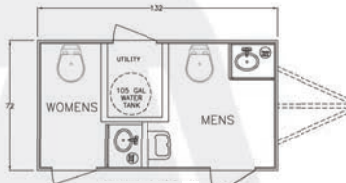

1102-W

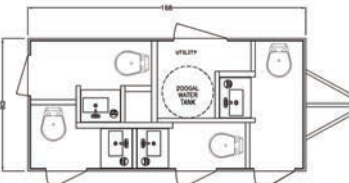

1404-W 4-D

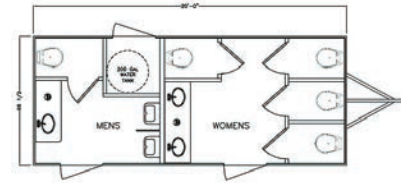

207-W

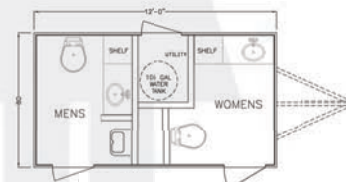

1202-W

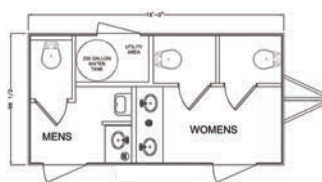

1804-W

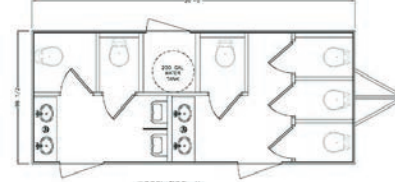

208-W

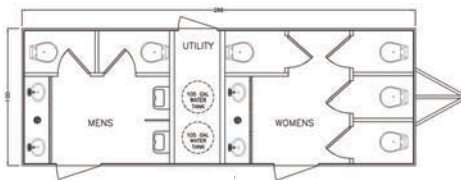
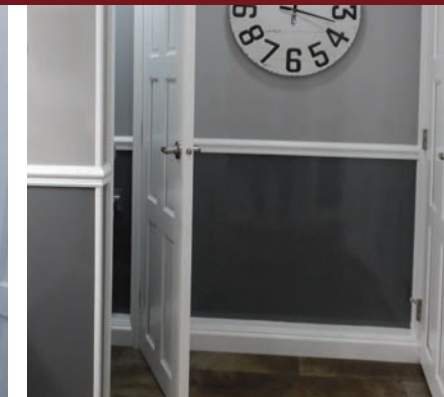
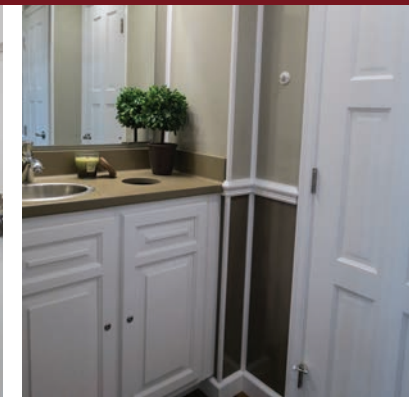
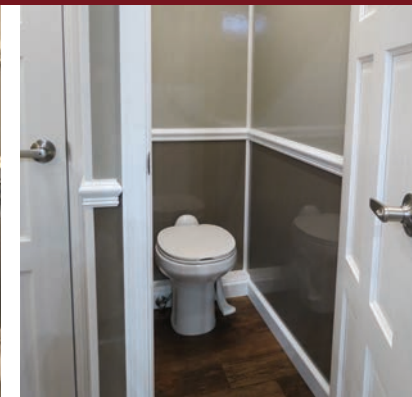

2408-W

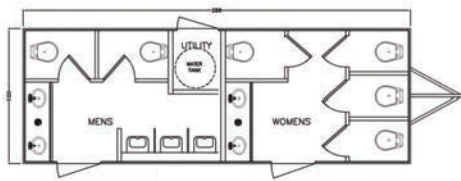

2409-W

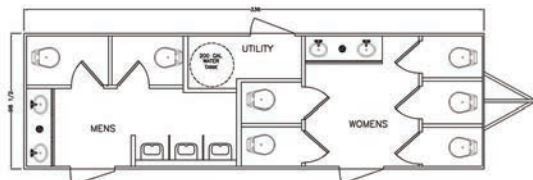

2810-W

### Standard Interior Features

- Custom Cabinetry & Trim - White
- Two-Tone Smooth Wall - Gray or Tan
- Smooth Fiberglass Ceiling Surface - White
- Heavy Duty Linoleum
- Solid Surface Counter Tops
- Stainless Steel Sinks with Chrome Fixtures
- Soap Dispensers (mounted in Counter Tops)
- China Foot Flush Toilets/Waterless Urinals - White
- Recessed LED Ceiling Lighting
- Safety Backed Glass Mirror



## FORTRESS ELITE

(Most popular floor plans available in Fortress Elite)

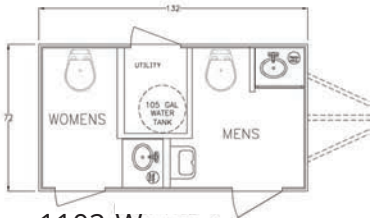

1102-W

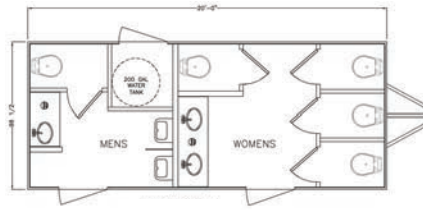

207-W

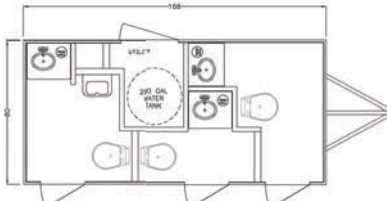

1403-W

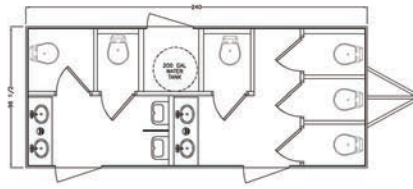

208-W

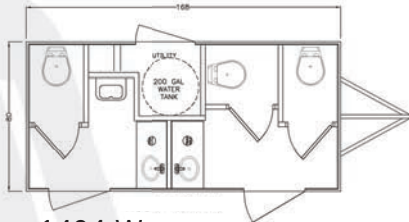

1404-W

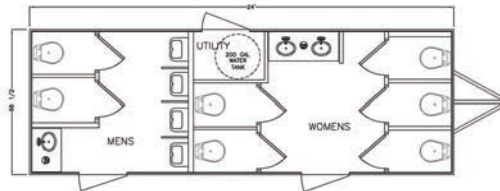

2411-W

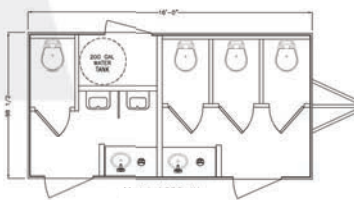

1806-W

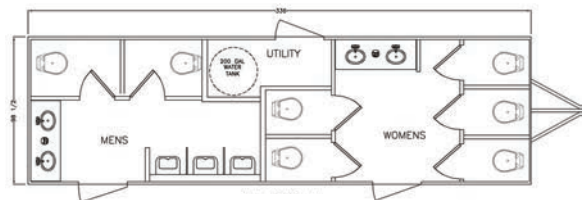

2810-W

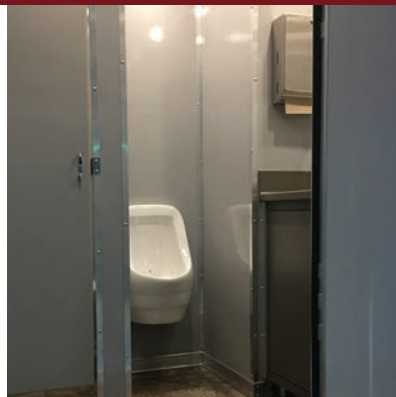
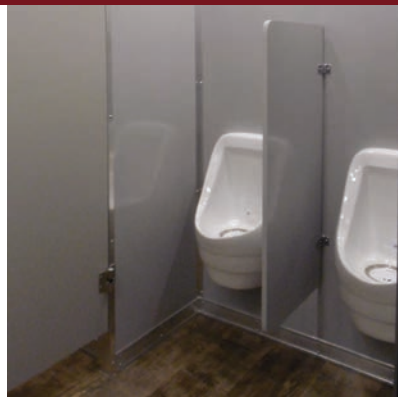

## Standard Interior Features

- Custom Aluminum Cabinets - Glimmer
- Smooth Wall - Gray
- Full Privacy Floor to Ceiling Stall Walls
- Marine Grade Polymer Stall Doors - Gray
- Aluminum Trim
- Smooth Fiberglass Ceiling Surface - White
- Heavy Duty Linoleum
- Solid Surface Counter Tops
- Stainless Steel Sinks / Chrome fixtures
- Metered Faucets
- China Foot Flush Stools
- Waterless Urinals--White
- LED Recessed Ceiling Lights
- Safety Backed Glass Mirror



# FORTRESS

(Most popular floor plans available in Fortress)

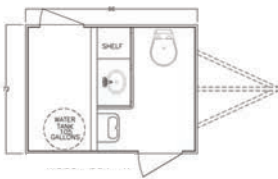

801-W

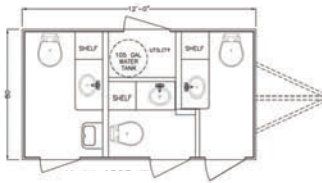

1203-W

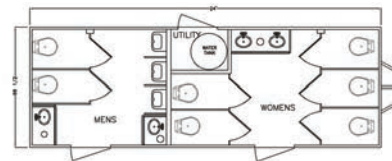

2410-W

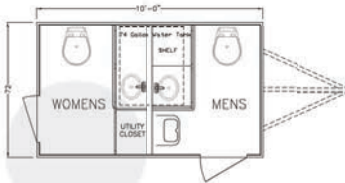

102-W

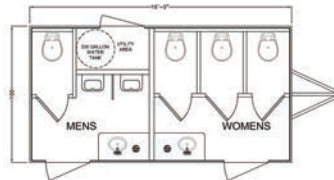

1806-W

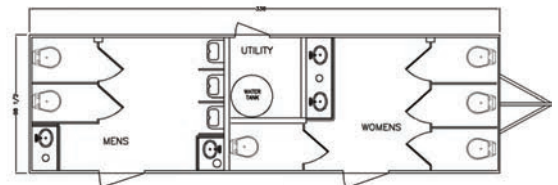

2809-W

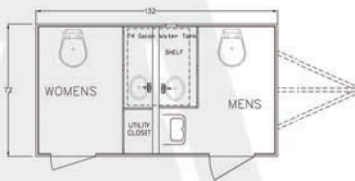

112-W



206-W

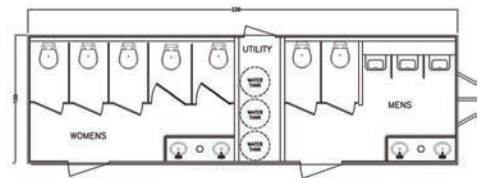

2810-W

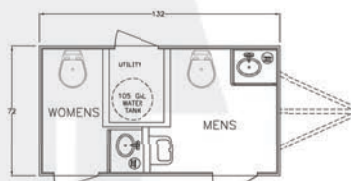

1102-W

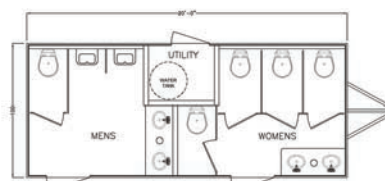

207-W

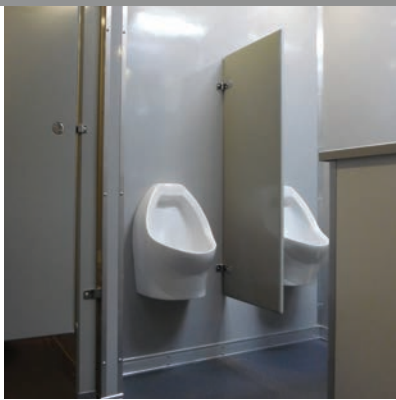

## Standard Interior Features

- Custom Aluminum Cabinets - White
- Smooth Wall - Gray
- Smooth Fiberglass Ceiling Surface - White
- Aluminum Trim
- Rubberized Flooring
- Steel Partitions
- Stainless Steel Sinks with Chrome Fixtures
- China Foot Flush Toilets/Waterless Urinals - White
- Recessed LED Ceiling Lighting
- Safety Backed Glass Mirror



**SHOWER AND COMBINATION**

*(Most popular floor plans available in Shower and Combination)*

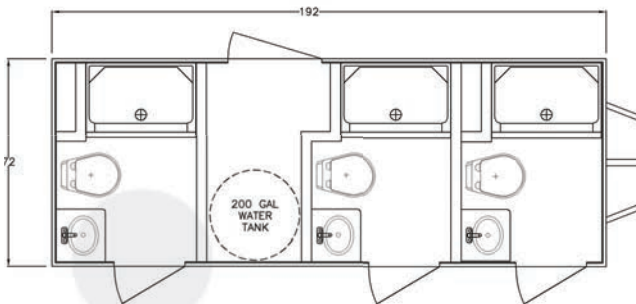

COM 1603-W

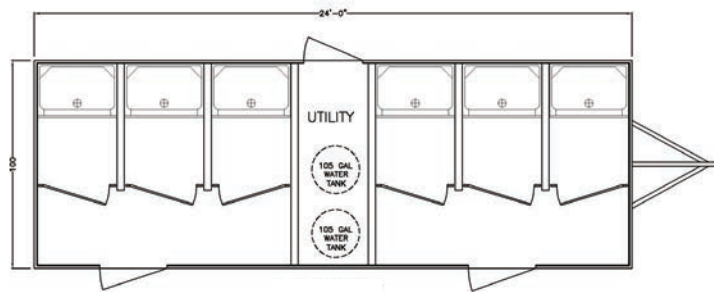

SHO-24

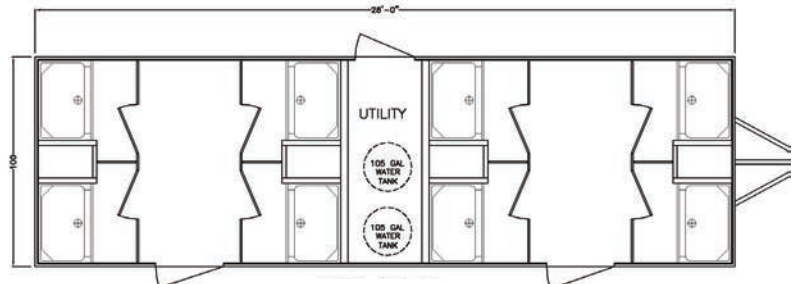

SHO-28





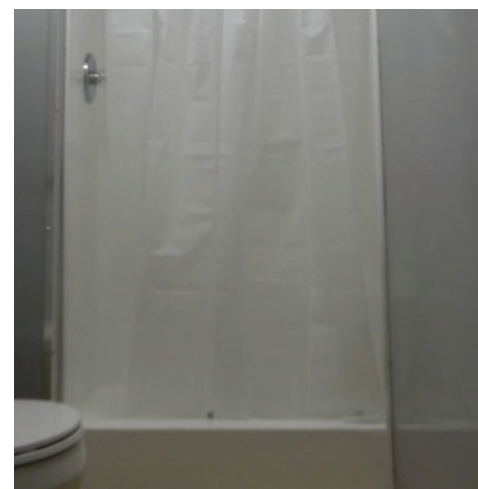
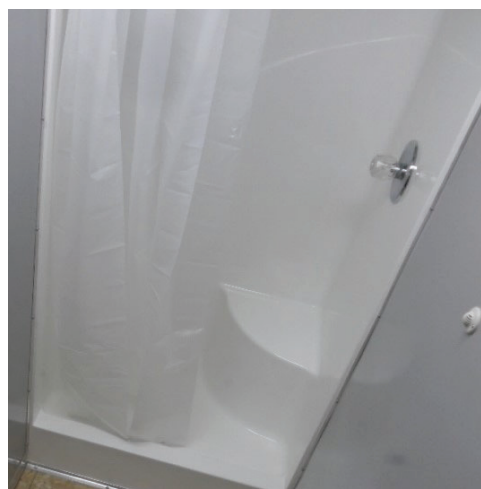

## Standard Interior Features

- *Smooth Wall - Gray or Tan*
- *Aluminum Trim*
- *Smooth Fiberglass Ceiling Surface - White*
- *Rubberized Flooring - Seamless*
- *Shower Surround Stalls with Levered Temperature Control*
- *Shower Curtains and Rods*
- *Fluorescent Ceiling Lights (Vapor Sealed)*
- *Roof Air Vents with Fans and Rain Covers*
- *Safety Backed Glass Mirror (1 per side)*

## ALL MODELS STANDARD AND OPTIONAL FEATURES

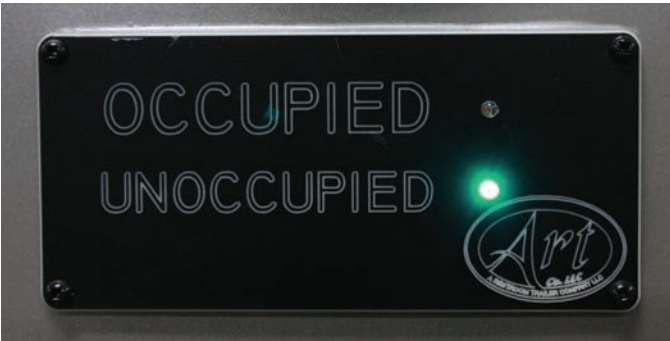

### Standard Features\*

- Heavy Duty Undercoated Steel Frame
- Heavy Duty 2-5/16 Trailer Hitch
- Torsion Axles with Brakes and EZ Lube Hubs
- DOT Safety and LED Exterior Light Package
- 7 Way Plug and Break Away Cable
- Switched Porch Light at Each Entry Door
- Integral Trailer Skirting
- Fastenerless Exterior
- Seamless Aluminum Roof
- Drip Cap Over Each Entry Door
- Waste Tank Site Gauge & 3" Banjo Valve
- Ducted AC with Heat Strip
- Twist Lock Cords
- Deep Cell Battery with Disconnect
- AC/DC Converter Charger
- City Water Hookup
- Metered Faucets
- Leveling Jacks
- Fold Down and Roll Out Step Assembly

### Options\*

- Fiberglass Gelcoat Exterior
- FM / BT / USB / CD Stereo
- Heat and Winter Packages
- Occupancy Sensors
- Hands Free Faucets
- Interchangeable Gender Indicators
- Push Button Toilets
- Spare Tire
- Interior Pocket Doors
- Others Too Numerous to Mention

\* Standard features and options availability vary by model.



EXTERIOR COLOR SELECTIONS

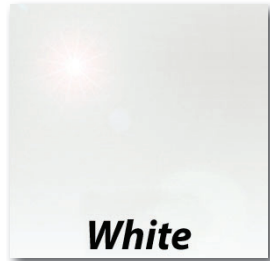

**White**

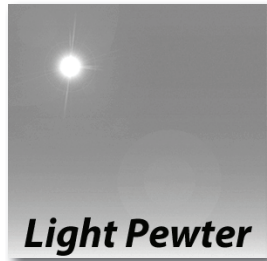

**Light Pewter**



**Champagne**



**Charcoal**

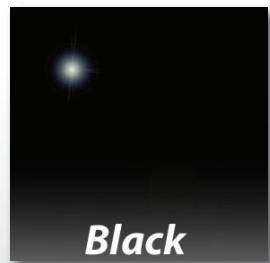

**Black**



**Green**



**Red**

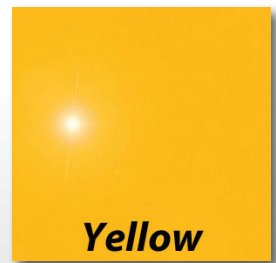

**Yellow**



Ph: (269) 435-4278

Fx: (269) 435-4507

P.O. Box 97

67351 U.S. 131

Constantine, MI 49042

[www.arestroomtrailer.com](http://www.arestroomtrailer.com)